

## Wolkenbügel EuroCity Berlin

**competition** mixed-used neighborhood with diverse apartment types, shops and a kindergarten **Ort** Berlin, Germany **client** Stadthafenquartier Europacity Berlin GmbH **size** 1,7ha, 26.150m<sup>2</sup> GFA **status** project 2013 **project team** Anne Niehüser, Arne Hansen, Oliver Seidel, Sanna Richter **cooperation** Mark Niehüser, Drewes + Speth Ingenieure, Institute for Building and Solar Technologies, University Braunschweig

“... In the front the Baltic Sea, in the back the Friedrichstraße ...“  
In the EuroCity Berlin one can come close to this ideal. The design combines an urban block typology with a distinctively shaped bar - “the Wolkenbügel”. Its shape is characterized by a large void. This wide passage connects the block via the neighborhood square with the water front and at the same time the waterfront with the city. The void forms a partially covered urban stage for public uses such as weekly market, game or sport and thus a lively place along the promenade. The block is orientated to a central courtyard, which is connected to the neighborhood square. The block is divided into ten different houses whose building height of seven floors decreases stepwise to five. All roofs are used as terraces. According to the different housing typologies and sizes the widths of the houses vary as well. The houses are also distinguished in terms of facade rhythm and materiality.

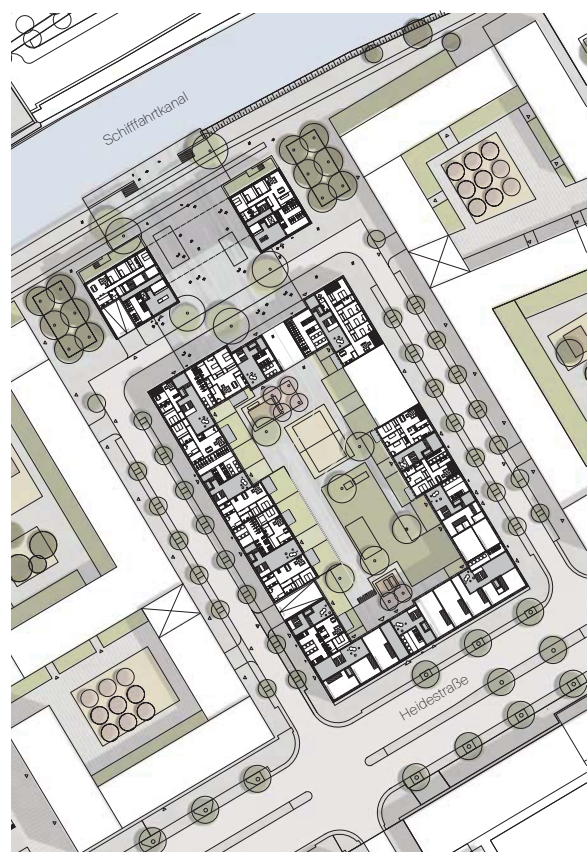

site plan: opening up to the Schiffahrtskanal



Wolkenbügel and the square at the waterfront



floor plan "Wolkenbügel"



section and elevation of block and Wolkenbügel



residential block: view from Heidestraße