

Unusual living KIDS

concept study for sustainable and integrated urban development **location** Bremen, Germany **size** 10ha **client** GEWOBA AG Bauen und Wohnen **services** urban planning concept, open space and traffic concept, child-friendly presentation of the idea **status** idea **team** Verena Brehm, Jakob Bohlen, Imke Hullmann **award** 1. prize

In Germany, 90% of all children live in cities - 60% in large and medium-sized cities alone.

The concept study takes this as an opportunity to redesign the existing housing estate on Bürgermeister-Reuter-Straße in Bremen Vahr according to the principles of a child-friendly city. The settlement shows various potentials in open space as well as in the building stock. In addition to the location on Lake Vahr, the rich tree population and the generous open spaces, the sealed parking spaces, the repetitive, underused open spaces, and the missing center pose challenges.

In phase 0, a footbridge will be built that connects the neighborhoods with each other and interweaves the settlement with the network of paths in the area. It creates a center for the entire quarter, creates an address on Kurt-Schumacher-Allee, invites you to the quarter, and leads to the water. This is where people play, romp, rest, chat, celebrate, cook - a meeting point and link between the neighborhoods.

The redensification strategy is subordinate to the maintenance of the valuable tree population and is divided into measures of upgrading, increasing, and adding. New forms of living promote the social mix in the neighborhood and enable new, diverse family structures and forms of living together in the long term.

A central neighborhood garage on the main street, supplemented with decentralized mobile stations, enables a car-free neighborhood - this increases security, which at the same time brings more space to play on the street.

The open space is made usable in the form of private gardens, neighborhood islands, playgrounds, and the "children's wilderness". The footbridge offers various areas of play - also for informal play and nature experiences.

In the climate-neutral quarter, the roofs are activated as blue-green solar roofs. The rainwater is collected, stored, and evaporated. Biodiversity is promoted and made visible through bee pastures, hedges, and orchards. The footbridge leads as a research path through the future-oriented quarter. There, children can play close to nature and explore relationships between themselves and their environment. Sustainable use of resources can be learned in childhood.



free space



phase 0

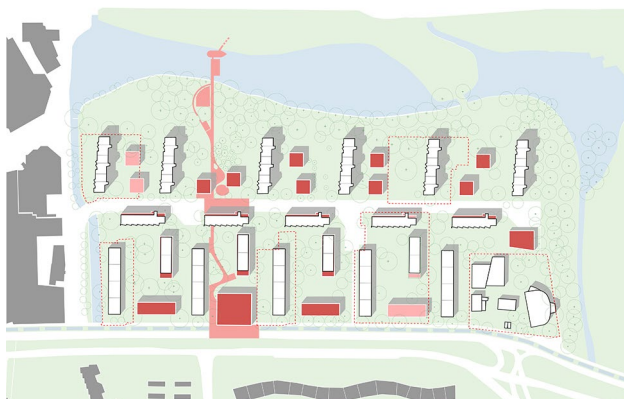

common space

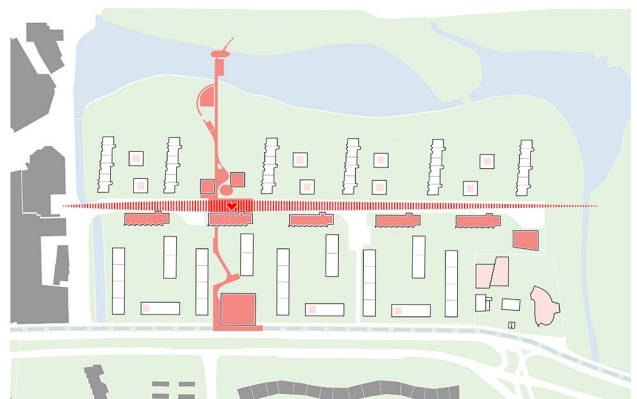

pathways: bike & pedestrian orientation

